

Model CPM TUBULAR TYPE MAGNETIC SEPARATOR

CPM sanitary specification

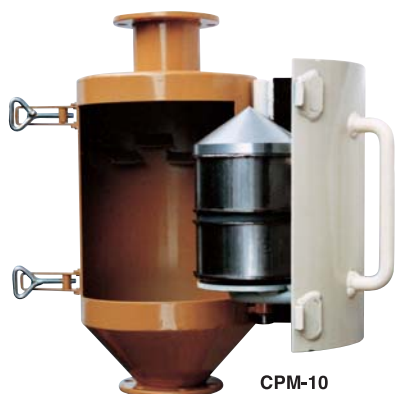

CPM-10



[Application]

A tubular separator incorporating a powerful columnar permanent magnet. When this separator is installed in a system to flow such nonmagnetic substances as powder and bulk materials, mixed iron pieces, etc. can be removed. This separator has a construction suitable for vertical falling flow operations.

[Features]

- Eight models are available by cylinder sizes to meet various mounting shapes.
- The magnet is housed in a robust steel tube for protection against impacts by powder and bulk materials.
- The opening hatch facilitates removal of iron pieces.
- While the iron-removal rate is very high, the installation cost is low and almost no running cost is required.
- The transfer line and processing equipment are protected against damage by iron pieces.
- Possible spark formation of powder and bulk materials can be prevented.
- The quality and purity can be increased and reliability can be enhanced.

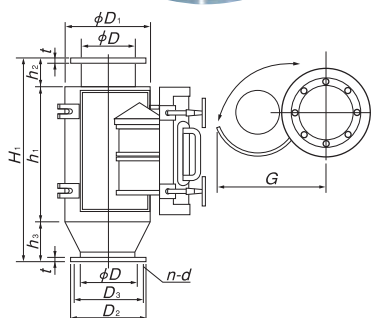
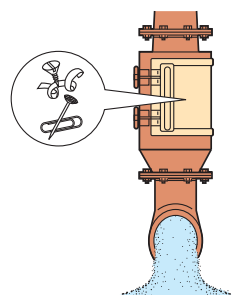

[mm (in.)]

Model	Flow Capacity	ϕD	ϕD_1	H	h_1	h_2	External Dimensions	D_1	D_2	$n-d$	t	G	Mass
CPM- 5	1 m ³ /h	61 (2.40)	145 (5.70)	310 (12.2)	195 (7.67)	50 (1.96)	65 (2.55)	130 (5.11)	105 (4.13)	6 (0.23) - $\phi 10$ (0.39)	8 (0.31)	200 (7.87)	6kg/ 13 lb
CPM-10	2.5m ³ /h	102 (4.01)	220 (8.66)	570 (22.4)	370 (14.5)	70 (2.75)	130 (5.11)	190 (7.48)	155 (6.10)	8 (0.31) - $\phi 10$ (0.39)	8 (0.31)	300 (11.8)	20kg/ 44 lb
CPM-15	6 m ³ /h	165 (6.49)	275 (10.8)	680 (26.7)	430 (16.9)		150 (5.90)	265 (10.4)	230 (9.05)	8 (0.31) - $\phi 10$ (0.39)	8 (0.31)	310 (12.2)	22kg/ 48 lb
CPM-20	10 m ³ /h	216 (8.50)	345 (13.5)	790 (31.1)	520 (20.4)		170 (6.69)	320 (12.6)	280 (11.0)	12 (0.47) - $\phi 10$ (0.39)	8 (0.31)	390 (15.3)	30kg/ 66 lb
CPM-25	15 m ³ /h	267 (10.5)	435 (17.1)	950 (37.4)	580 (22.8)	100 (3.93)	270 (10.6)	385 (15.2)	345 (13.5)	12 (0.47) - $\phi 10$ (0.39)	8 (0.31)	485 (19.1)	45kg/ 99 lb
CPM-30	20 m ³ /h	319 (12.5)	485 (19.1)	1000 (39.3)	600 (23.6)		300 (11.8)	430 (16.9)	390 (15.3)	12 (0.47) - $\phi 10$ (0.39)	8 (0.31)	680 (26.7)	60kg/ 132 lb
CPM-40	35 m ³ /h	406 (15.9)	620 (24.4)	1100 (43.3)	700 (27.5)		300 (11.8)	540 (21.2)	495 (19.4)	12 (0.47) - $\phi 10$ (0.39)	8 (0.31)	715 (28.2)	85kg/ 187 lb
CPM-50	55 m ³ /h	508 (20.0)	780 (30.7)	1200 (47.2)	780 (30.7)		320 (12.6)	655 (25.7)	605 (23.8)	12 (0.47) - $\phi 10$ (0.39)	8 (0.31)	885 (34.8)	110kg/ 242 lb

※A sanitary spec version is also available upon request.

MEASURING INSTRUMENTS

Model TM TESLA METER

Meter in Compliance with New Measurement Law

Measuring data output function incorporated



TM-701

The TESLA meter is a practical, handy type Gaussmeter having digital display that has been developed based on KANETEC's long experience and achievements in the manufacture of magnetism-applied products.

From the user's point of view, this meter is designed for easy use by anyone by incorporating frequently used functions only.

The external output terminal is also provided to enable digital or analog outputs. Further, the probe has been made smaller for measurement in smaller space.

[Application]

- Measurement of residual magnetism in machined workpieces.
- Measurement of magnetic flux in magnetism-applied products.
- Measurement of magnetic flux of motors.
- Measurement of properties of magnetic materials.

[Features]

- A wide range of measuring range from 0 to 3000 mT (0 — 30,000 G). (DC)
- The battery life has been increased by about 30%.
- The rigidity of the probe has been increased.
- The meter can be operated with a chargeable battery also.
- By connecting an optional cable (TM-601DTC) to the external output terminal, digital (analog possible) data can be transferred to a PC.
- The alternate magnetic flux density, in addition to direct magnetic flux density, can be measured. (50/60 Hz)
- The high resolution measuring mode ensures more accurate measurement. (Resolution 0.01 mT = 0.1 G)
- The unit of display can be changed over between "mT" and "G".
- High dustproof by use of sheet keys.
- The auto power off function prevents useless waste of the battery.
- When the probe has been worn out, it can be replaced with a new one without troublesome calibration. (Optional)

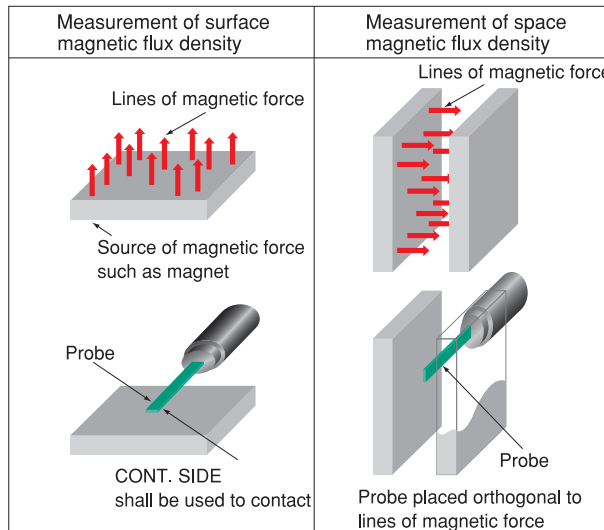
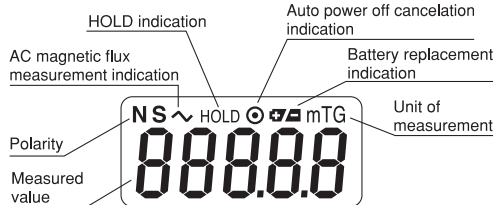

(1mT=10G)

Model					TM-701					Function		Zero reset		Polarity indication						
Detecting Contents					DC magnetic flux density Polarities (N, S)					AC magnetic flux density (50/60Hz)					Max. detect value hold		Auto power off (can be canceled)			
Measuring					mT/G selection			IT=10000G		Display		LCD								
Indication Range					0—3000.00mT										Mode		Detection value		Numeric value (digital)	
Measuring Mode					Measuring mode		Measuring range		Resolution		Indication accuracy			Operating Temperature		0—+40℃ (104°F)				
Measuring Range					DC×1※		0— 200.0 mT		0.1 mT		± (5%of rdg.+ 3digit)			Power Source		Battery SUM-3 (1.5 V) × 4 pieces				
Resolution					DC×10		0— 300.00mT		0.01mT		± (5%of rdg.+ 5digit)			Dimensions		Height 140mm (5.51)×width 64 (2.51)mm×thickness 30 (1.18) mm				
Indication Accuracy					AC×1※		0— 200.0 mT		0.1 mT		± (5%of rdg.+ 20digit)			Mass		Approx. 250 g/0.55 lb (including batteries and probe)				
					AC×10		200.1—1500.0 mT		1 mT					Accessories		Probe, batteries and carrying case				
					AC×10		0— 150.00mT		0.01mT					Option		Digital output cable (TM-601DTC) Axial probe (TM-701AXL)				

※ The measuring ranges are automatically selected.

Note: This product is not designed for measurement of electromagnetic waves.

Model TM MEASUREMENT PROBE FOR TESLA METER

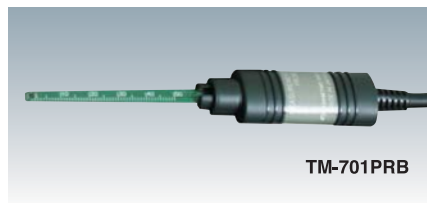

TM-701PRB

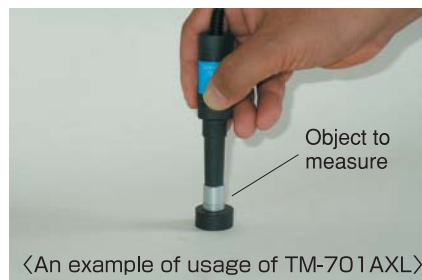
TM-701AXL
(Optional)Object to measure
〈An example of usage of TM-701AXL〉

- A probe dedicated to TM-701. Please keep this probe as a spare; it can be replaced without troublesome calibration. In addition to the standard PRB (transverse type), an axial type (AXL) capable of measurement in the vertical direction and having higher durability is optionally available.

[mm (in.)]

Model	Applicable Model	Tip Dimensions	Cord Length	Mass
TM-701PRB	Only for TM-701 *	(T) 1.0 (0.03) × (W) 3.5 (0.13) × (L) 65 (2.55)	1000 (39.3)	50g/0.11 lb (Including probe cap)
TM-701AXL		φ13 (0.51) × 55 (2.16)		

※ Can be used with Kanetec's conventional TM-501 and TM-601.

Model TM REFERENCE MAGNETIC FIELD FOR TESLA METER

[Application]

- Daily check of the Tesla meter.
- Calibration of the Tesla meter.

[Features]

- The closed circuit construction employing a permanent magnet that causes less magnetic force leak.
- Small and light weight.
- Usable with Kanetec TM-201 and above.



TM-SMF-050



[mm (in.)]

Model	Magnetic Flux Density *	Dimensions		Mass
		Frame Dia	Height	
TM-SMF-003	0.003T (30G)		50 (1.96)	Approx. 0.2kg/0.44 lb
TM-SMF-050	0.05 T (500G)	φ43 (1.69)	40 (1.57)	
TM-SMF-300	0.3 T (3000G)		30 (1.18)	Approx. 0.1kg/0.22 lb

※ The magnetic flux density of the product is the actual measured value.

Model TM DIGITAL SIGNAL OUTPUT CABLE FOR TESLA METER



To PC (RS-232C)

To Tesla meter
(external output terminal)TM-601DTC
(Optional)